

L I M I T E D T E N D E R
N O T I C E

Tender Ref. No.

Date

Tender Due Date

GFD-15/38/2019-MECH_SAM_CHENNAI-7758

28.08.2019

11.09.2019

To

Dear Sir,

The Purchase Officer, SAMEER-Centre for Electromagnetics invites sealed tender for the supply of materials as per details given below:

Sl.No	Description of Items	Qty Nos
1.	FCS Subracks Fabrication (As Per List & Drawings Attached)	3 Sets

Terms and Conditions

1. Price quoted should be on the basis of Destination delivery at Taramani Campus, Chennai 600 113.
2. Delivery / Completion period should be clearly indicated.
3. Excise Duty, GST Percentage should be clearly indicated if admissible. Not eligible for FORM 'C' /'D'
4. WE ARE EXEMPTED FROM EXCISE DUTY
5. Quotation should be valid for atleast 60 days from the date of opening of the tender
6. Quotation should be sent in sealed envelope super scribing the tender reference number and tender due date.
YOUR OFFER WILL NOT BE CONSIDERED IF OUR TENDER REFERENCE NO. & TENDER DUE DATE IS NOT MENTIONED ON COVER.
7. Late tenders will not be accepted under any circumstances
8. We reserve the right to accept or reject any quotations fully or partly without assigning any reasons.
9. For Further Clarification Please Contact 044-22544061 / 22544020 Email: purchase.chn.sameer@nic.in
10. Unsolicited bids shall not be considered

(P.Ramamoorthi)
Head - Administration
Contd...

FCS Subracks Fabrication 3 sets

Sl.No	Description of Items	Qty Nos
1.	Al. Cross Bar	12
2.	LH Channel	3
3.	RH Channel	3
4.	SS Cross Bar Top	3
5.	SS Cross Bar Bottom	3

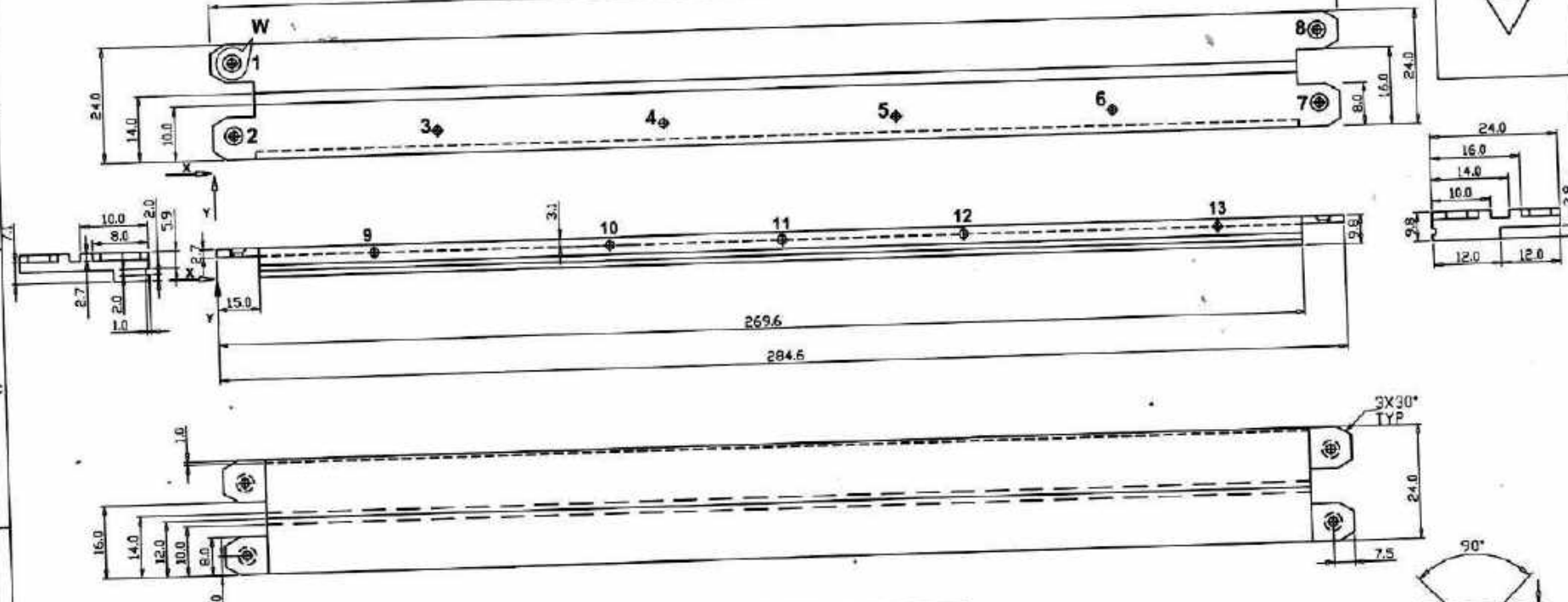

HOLES NO.	1	2	3	4	5	6	7	8	9	10	11	12	13
X±0.1	7.5	7.5	48.4	111.0	173.6	236.2	277.1	277.1	38.0	90.2	142.4	194.4	246.6
Y±0.1	20	4.0	4.0	4.0	4.0	4.0	4.0	20	3.1	3.1	3.1	3.1	3.1
HOLES DETAILS	Ø6 x 90° CSK & Ø3.2 THRU' HOLES (2 Places)		M3.0 Helicoll Tap 6.0mm Deep (4 Places)				Ø6 x 90° CSK & Ø3.2 THRU' HOLES (2 Places)		M3.0 Helicoll Tap 6.0mm Deep(5 Places)				

DETAILS OF 'W'

NOTES :

1. MATERIAL : ALUMINIUM (IS:64430)
2. QTY : 12 No's
3. FINISH : NATURAL
4. ALL OTHER TOLERANCE TO FOLLOW IS:2102-1993

	DRN	CHD	APPD	MATERIAL	TOLERANCE	FINISH
DATE				REFER NOTE	REFER TABLE	REFER NOTE
NAME	V.P	B.A	S.V	ALL DIMENSIONS IN mm. IF IN DOUBT ASK.		
SIGN				ALL OTHER TOLERANCE TO FOLLOW IS:2102-1993		
				REMOVE SHARP EDGES.		

DIMENSION	TOLERANCE	PROJECTION
* **	± 0.1	
* ** *	± 0.05	
* * * * *	± 0.005	
ALL OTHER TOLERANCE TO FOLLOW IS:2102-1993		SCALE NTS

TITLE:	
AL Cross Bar	
DWG NO:	AC-D-04
CODE NO :	
REV NO :	
SHEET NO :	of
SAMEER CENTRE FOR ELECTROMAGNETICS CHENNAI-600115	

Receipt No : 16666/2019/MECH-SMR_CHE

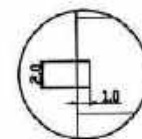
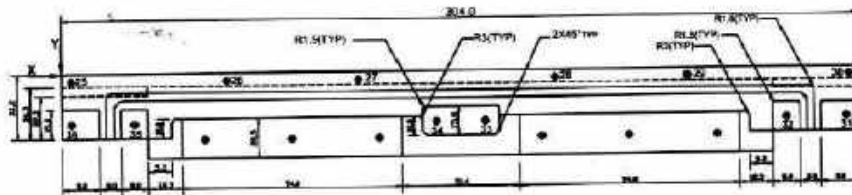

DETAILS OF 'B'

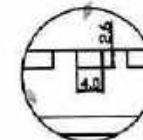

DETAILS OF 'C'

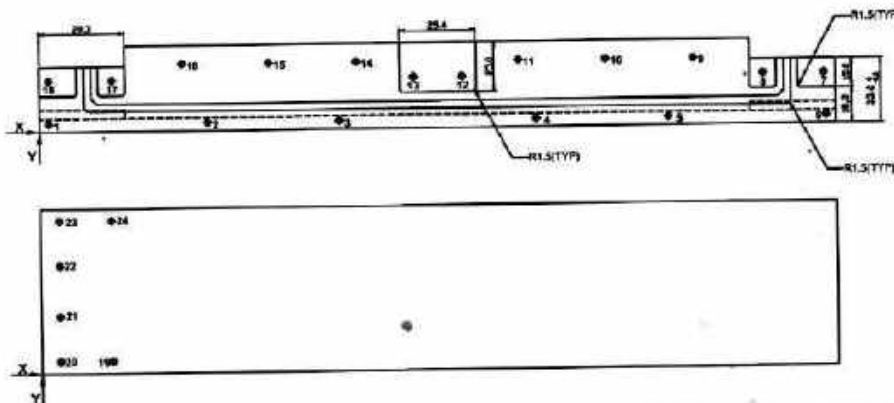
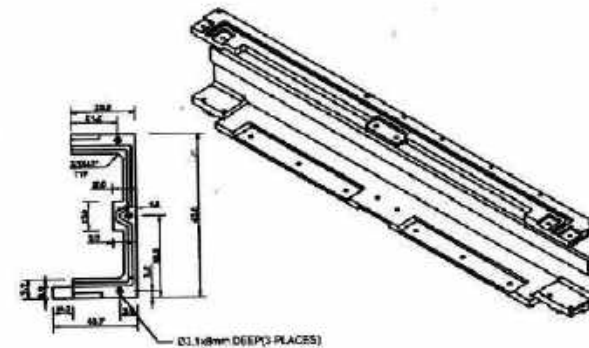
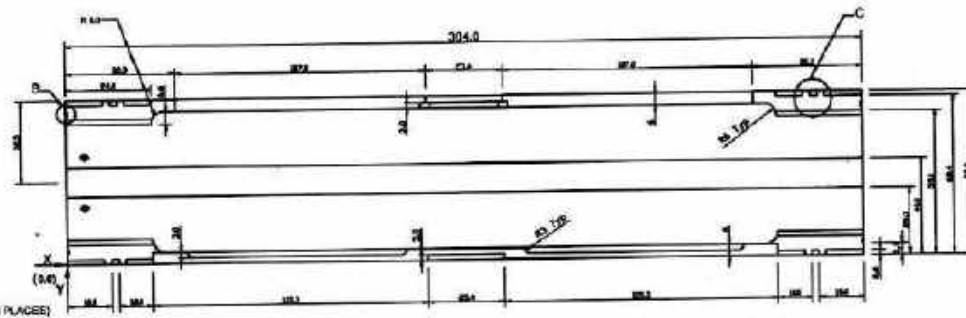
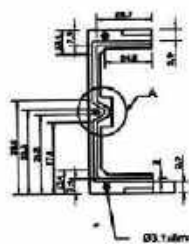

NOTES :

1. MATERIAL : ALUMINIUM (IS:64430)
2. QTY : 3 No's
3. FINISH : NATURAL
4. ALL OTHER TOLERANCE TO FOLLOW IS:2102-1993

HOLES NO.	1	2	3	4	5	6	7	8	9	10	11	12	13	14	15	16	17	18	19	20	21	22	23	24	25	26	27	28
X±0.1	4.0	59.2	122.4	181.6	240.8	300.0	300.0	284.0	244.7	214.7	184.7	158.7	145.3	119.3	89.3	59.3	29.0	4.0	37.0	10.0	10.0	16.0	16.0	37.0	4.0	63.2	122.4	
Y±0.1	4.0	4.0	4.0	4.0	4.0	4.0	25.7	25.7	33.7	33.7	33.7	24.2	24.2	33.7	33.7	28.7	29.7	5.0	5.0	23.0	42.0	60.0	60.0	4.0	4.0	4.0	4.0	
HOLES DETAILS	M3.5 Natural Top 6.0mm DEEP (2 PLACES)						M3.5 Natural Top 6.0mm DEEP (2 PLACES)						M3.5 Natural Top 7mm DEEP (2 PLACES)						M3.5 Natural Top 8.0mm DEEP (2 PLACES)									

HOLES NO.	28	29	30	31	32	33	34	35	36	
X±0.1	181.6	240.8	300.0	300.0	284.0	158.7	145.3	4.0	20.0	
Y±0.1	4.0	4.0	4.0	25.7	25.7	24.2	24.2	25.7	25.7	
HOLES DETAILS	M3.5 Natural Top 6.0mm DEEP (2 PLACES)		M3.5 Natural Top 6.0mm DEEP (2 PLACES)		M3.5 Natural Top 7mm DEEP (2 PLACES)		M3.5 Natural Top 8.0mm DEEP (2 PLACES)		M3.5 Natural Top 8.0mm DEEP (2 PLACES)	

DATE	DRW	CHK	APPD	MATERIAL	TOLERANCE	FINISH
				REFER NOTE	REFER TABLE	REFER NOTE
NAME	V.P	D.A	S.V	ALL DIMENSIONS IN mm UNLESS OTHERWISE SPECIFIED		
SGR				NANO'S BENCH MARK		

DIMENSION	TOLERANCE	PROJECTION	SCALE	TITLE
**	±0.1		SCALE RTS	LH CRIMING
***	±0.05			
****	±0.005			DWG NO: LH-C-0-00 REV NO: _____ SHEET NO: _____ of _____ SAMEER-CENTRE FOR ELECTROMAGNETICS CHENNAI-600132

Receipt No : 16667/2019/MECH-SMR_CHE

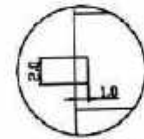
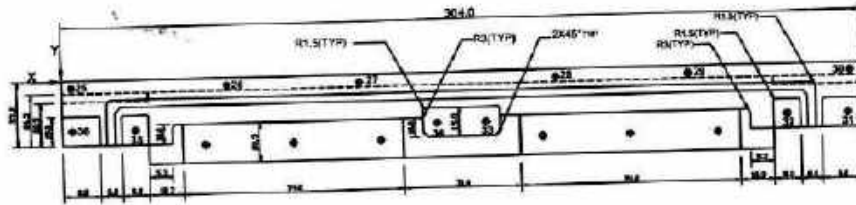

DETAILS OF 'B'

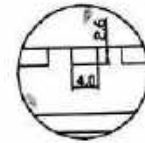

DETAILS OF 'C'

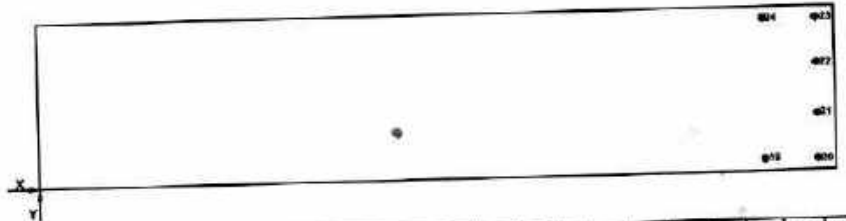
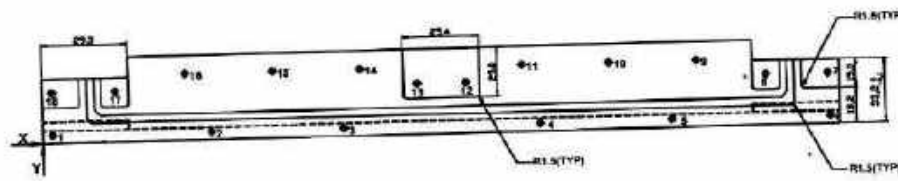
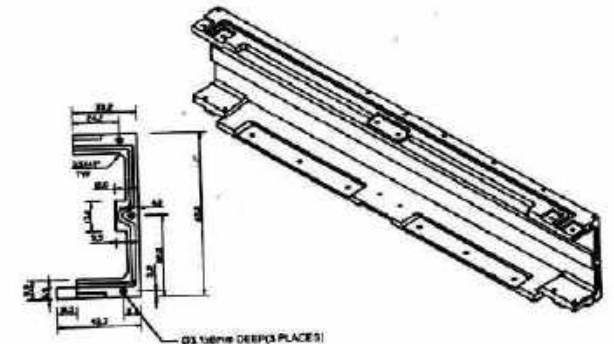
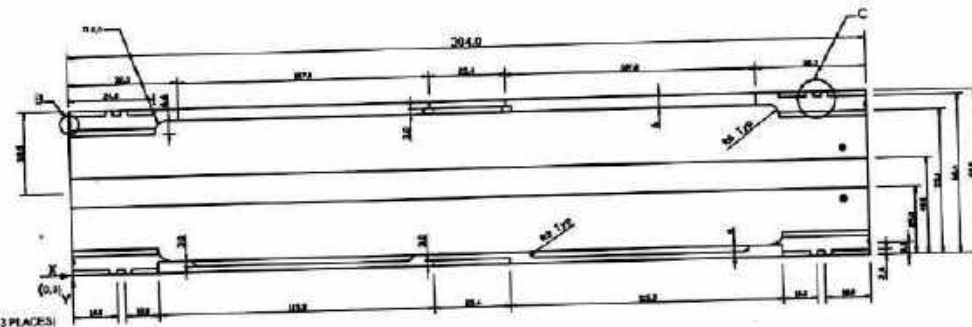
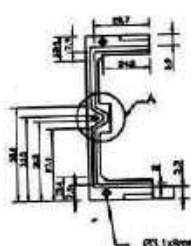
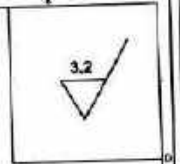

NOTES :

1. MATERIAL : ALUMINIUM (IS:64430)
2. QTY : 3 No's
3. FINISH : NATURAL
4. ALL OTHER TOLLORANCE TO FOLLOW IS:2102-1993

HOLES NO.	1	2	3	4	5	6	7	8	9	10	11	12	13	14	15	16	17	18	19	20	21	22	23	24	25	26	27
X83.1	4.0	59.2	122.4	181.6	240.8	300.0	359.2	284.0	244.7	214.7	184.7	158.7	145.3	119.3	88.3	59.3	28.8	4.0	257.4	294.0	294.0	294.0	204.8	287.4	4.0	63.2	122.4
Y20.1	4.0	4.0	4.0	4.0	4.0	4.0	25.7	25.7	33.7	33.7	33.7	24.2	24.2	33.7	33.7	33.7	25.7	25.7	3.0	5.0	23.0	42.0	60.0	60.0	4.0	4.0	4.0
HOLES DETAILS	Ø3.1 chamf Top & chamf DEEP (3 PLACES)						Ø3.1 chamf Top & chamf DEEP (3 PLACES)			Ø3.1 chamf Top THRU HOLE IN PLACES						Ø3.1 chamf Top & chamf DEEP (3 PLACES)						Ø3.1 chamf Top & chamf DEEP (3 PLACES)					

HOLES NO.	28	29	30	31	32	33	34	35	36
X10.1	181.6	240.8	300.0	359.2	284.0	158.7	145.3	4.0	20.0
Y26.1	4.0	4.0	4.0	25.7	25.7	24.2	24.2	25.7	25.7
HOLES DETAILS	Ø3.1 chamf Top & chamf DEEP (3 PLACES)			Ø3.1 chamf Top & chamf DEEP (3 PLACES)			Ø3.1 chamf Top THRU HOLE IN PLACES		

DRN	CFB	APPD	MATERIAL	TOLERANCE	FINISH	
DATE	REF'S NOTE	REFER TABLE	REFER NOTE			
NAME	V.P.	S.A.	S.V.	ALL DIMENSIONS IN MM. P.D. COULD APPL.		
SIGN	ALL OTHER TOLERANCE TO FOLLOW IS:2102-1993					
DIMENSION			TOLERANCE	PROJECTION	TITLE	
* * *			± 0.1		RH CHITRAI	
* * * *			± 0.05		DWG NO: 1910-B-02	DATE NO: 1
* * * * *			± 0.005		SHEET NO: 1	
ALL OTHER TOLERANCE TO FOLLOW IS:2102-1993						
SCALE			DATE	SAMEER CENTRE FOR ELECTROMAGNETICS CHENNAI-600113		

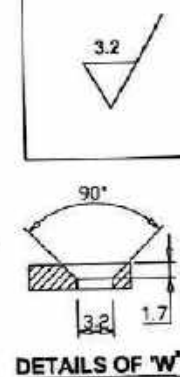
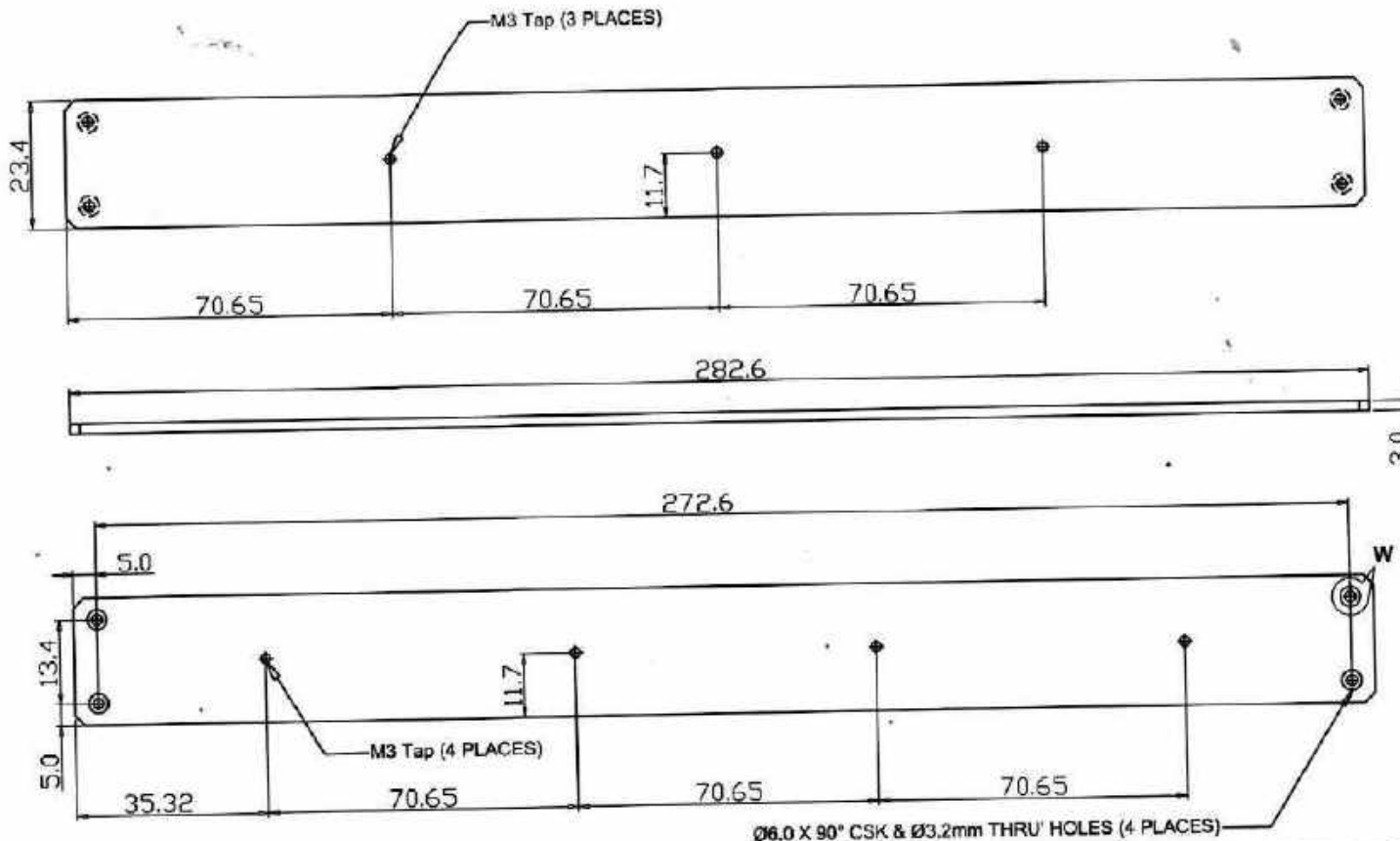

NOTES :

1. MATERIAL : STAINLESS STEEL (GRADE 316)
2. QTY : 03 NO'S
3. FINISH : NATURAL
4. ALL OTHER TOLERANCE TO FOLLOW IS:2102-1993

DRN	CHD	APPD	MATERIAL	TOLERANCE	FINISH
DATE			REFER NOTE	REFER TABLE	REFER NOTE
NAME	VP	B.A	S.V	ALL DIMENSIONS IN mm. IF IN DOUBT ASK.	
SIGN				ALL OTHER TOLERANCE TO FOLLOW IS:2102-1993	
REMOVE SHARP EDGES.					

DIMENSION	TOLERANCE	PROJECTION
_	± 0.1	
*_**	± 0.05	
*_***	± 0.005	
ALL OTHER TOLERANCE TO FOLLOW IS:2102-1993		SCALE NTS

TITLE: S.S. CROSS BAR - BOTTOM	
DWG NO: SSCB-D-06	CODE NO :
	REV NO :
	SHEET NO : of
SAMEER- CENTRE FOR ELECTROMAGNETICS CHENNAI-600113	

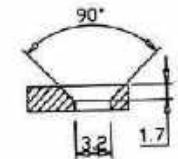
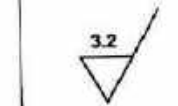
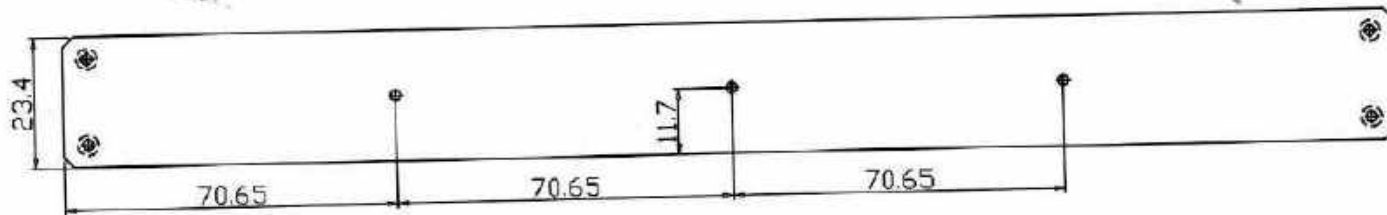

DETAILS OF 'W'

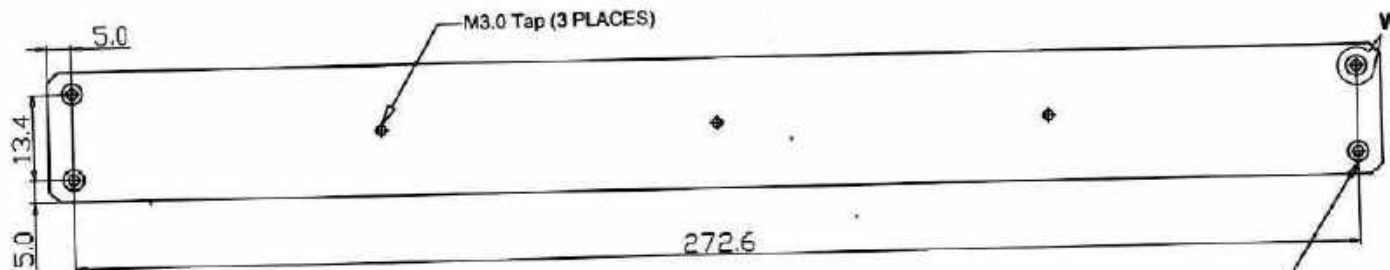
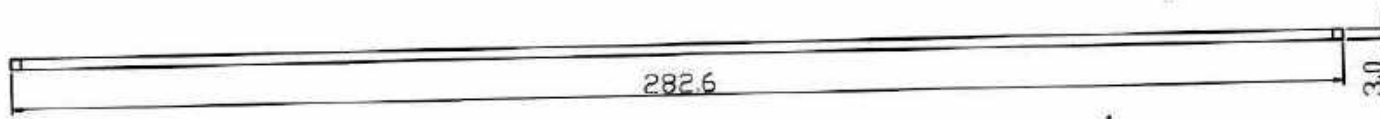

Ø6.0 X 90° CSK & Ø3.2mm THRU' HOLES (4 PLACES)

NOTES :

1. MATERIAL : STAINLESS STEEL (GRADE 316)
2. QTY :03 No's
3. FINISH : NATURAL
4. ALL OTHER TOLERANCE TO FOLLOW IS:2102-1993

DRN	CHD	APPD	MATERIAL	TOLERANCE	FINISH
DATE			REFER NOTE	REFER TABLE	REFER NOTE
NAME	VP	B.A	S.V	ALL DIMENSIONS IN mm. IF IN DOUBT ASK.	
SIGN				ALL OTHER TOLERANCE TO FOLLOW IS:2102-1993	
				REMOVE SHARP EDGES.	

DIMENSION	TOLERANCE
* . *	± 0.1
* . **	± 0.05
* . ***	± 0.005
ALL OTHER TOLERANCE TO FOLLOW IS:2102-1993	

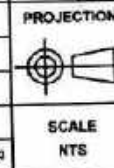

SCALE
NTS



TITLE: S.S. CROSS BAR - TOP	
DWG NO: SSCT-D-05	CODE NO :
	REV NO :
	SHEET NO : of
SAMEER - CENTRE FOR ELECTROMAGNETICS CHENNAI-600113	